

Floor Plan: Evergreen Seniors Community Centre

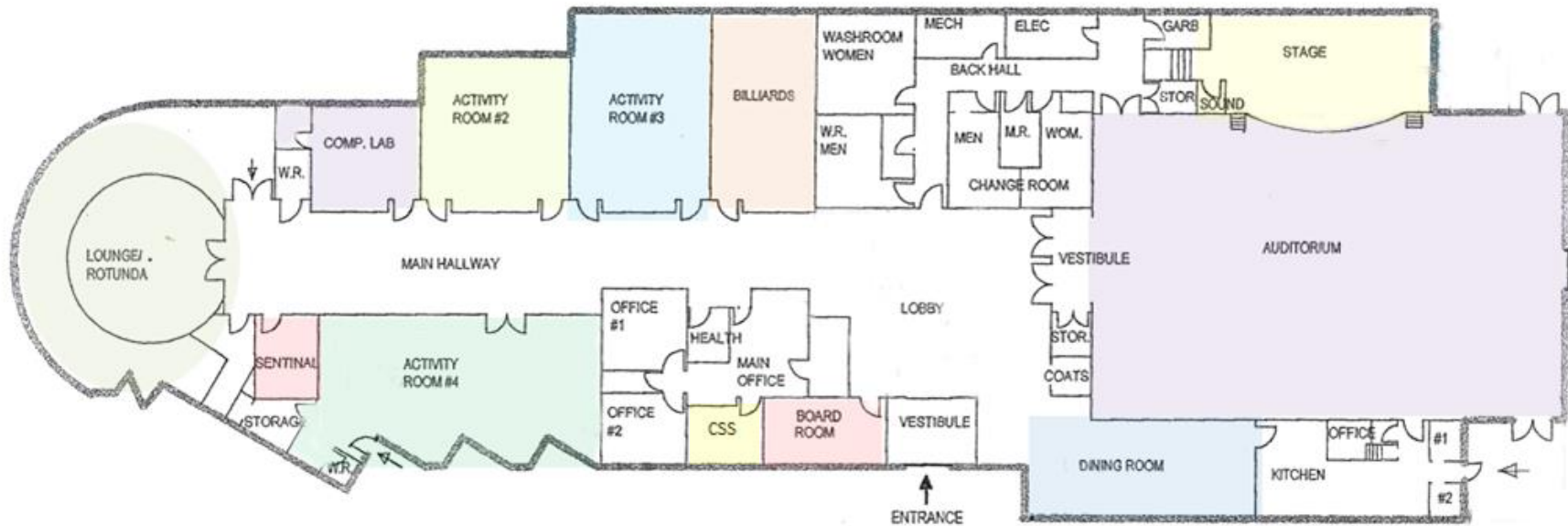

LEGEND

1.	Computer Lab	21' x 24' (504 sq ft)	12.	Sentinel Office	13' x 13.75' (175 sq ft)	27.	Technology Room	7' x 10' (70 sq ft)
2.	Activity Room#2	28'K30'(870 sq ft)	13.	Health Room	9.5' x 9.5' (90 sq ft)	28.	Kitchen	20' x 33'(560 sq ft)
3.	Activity Room # 3	28' x 41' (1148 sq ft)	14.	Auditorium	62' x 94.5' (5860 sq ft)	28a.	Kitchen Storage #1	7' x 8' (56 sq ft)
4.	Activity Room #4	31' x 58' (1670 sq ft)	15.	Auditorium Stage	20' x 45' (900 sq ft)	28b.	Kitchen Storage #2	8' x 8' (64 sq ft)
4a.	Washroom- Rm #4	8' x 6' (64 sq ft)	16.	Auditorium Storage	8' x 8' (64 sq ft)	28c.	Kitchen Washroom	5' x 5' (25 sq ft)
4b.	Storage Rm- #4	10' x 14' (97 sq ft)	17.	Auditorium Sound	6' x 7.5' (50 sq ft)	28d.	Kitchen Office	8' x 13.5' (83 sq ft)
5.	Billiard Room	21' x 41'(860 sq ft)	18.	Back hallway	Irregular (547 sq ft)	28e.	Kitchen Hallway	3' x 8' (24 sq ft)
6.	Board Room	15' x 26' (309 sq ft)	19.	Change Room- Women	Irregular (322 sq ft)	29.	Main Office	Irregular (420 sq ft)
7.	Book Nook- Rotunda	31' dia. (755 sq ft)	20.	Change Room- Men	Irregular (241 sq ft)		Office #1	14' x 15.3' (210 sq ft)
8.	Lobby	36' x 43' (1550 sq ft)	21.	Washroom- Men	Irregular (238 sq ft)		Office #2	14'x 15' (206 sq ft)
8a.	Cloak Room	9' x 9' (81 sq ft)	22.	Washroom- Women	Irregular (373 sq ft)	29a.	CSS Offices (GWSA)	14'x 16' (236 sq ft)
9.	Hallway - Main	20' x 120' (2150 sq ft)	23.	Maintenance Room	7.5' x 15' (97 sq ft)	30.	Mechanical Room	9' x 18' (162 sq ft)
9a.	Washroom	7' x 11' (77 sq ft)	24.	Storage - Back Hall	4' x 14'(56 sq ft)	31.	Electrical Room	9'x 18' (162 sq ft)
10.	Entrance Vestibule	10.5'x 17.5' (183 sq ft)	25.	Storage Room- Games	. 6' x 7' (42 sq ft)	32.	Table and Chairs	
11.	Evergreen Dining Room	20' x 52' (1040 sq ft)	26.	Garbage Room	8' x 12' (96 sq ft)	33.	WECC	11' x 16.5' (181 sq ft)